

# WAYNE & SILVER

Platts Lane, London, NW3 7NR  
Price Guide £700,000









# Platts Lane

London, NW3 7NR

A bright and spacious top floor apartment situated within this semi-detached red brick period conversion. The property comprises of a large reception room with exceptionally high ceilings and sky light, separate fully fitted kitchen, two double bedrooms with fitted wardrobes and family bathroom.

Further benefits include a private south-east facing roof terrace offering attractive green views.

Platts Lane is conveniently located for the various transport links on Finchley Road (Jubilee & Metropolitan lines), the boutiques and restaurants of Hampstead Village and the open green spaces of Hampstead Heath











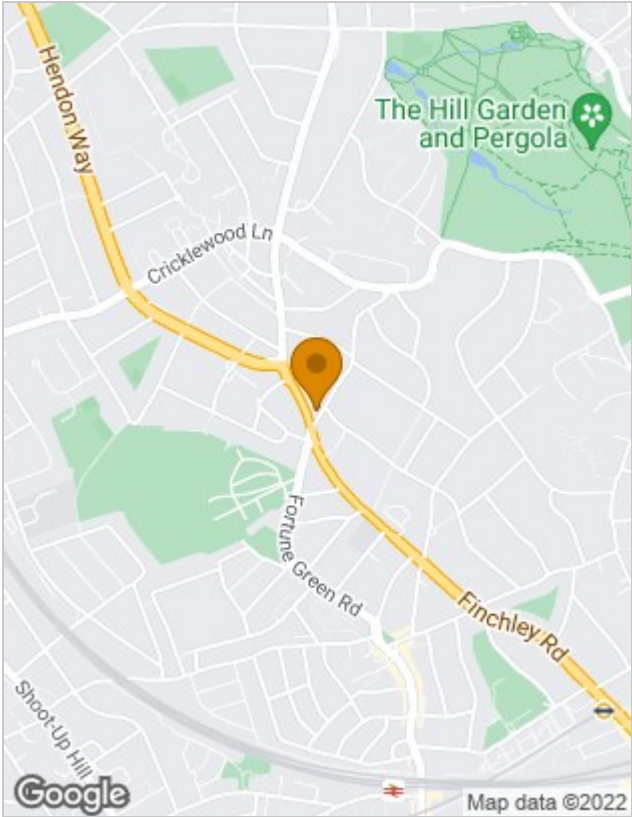
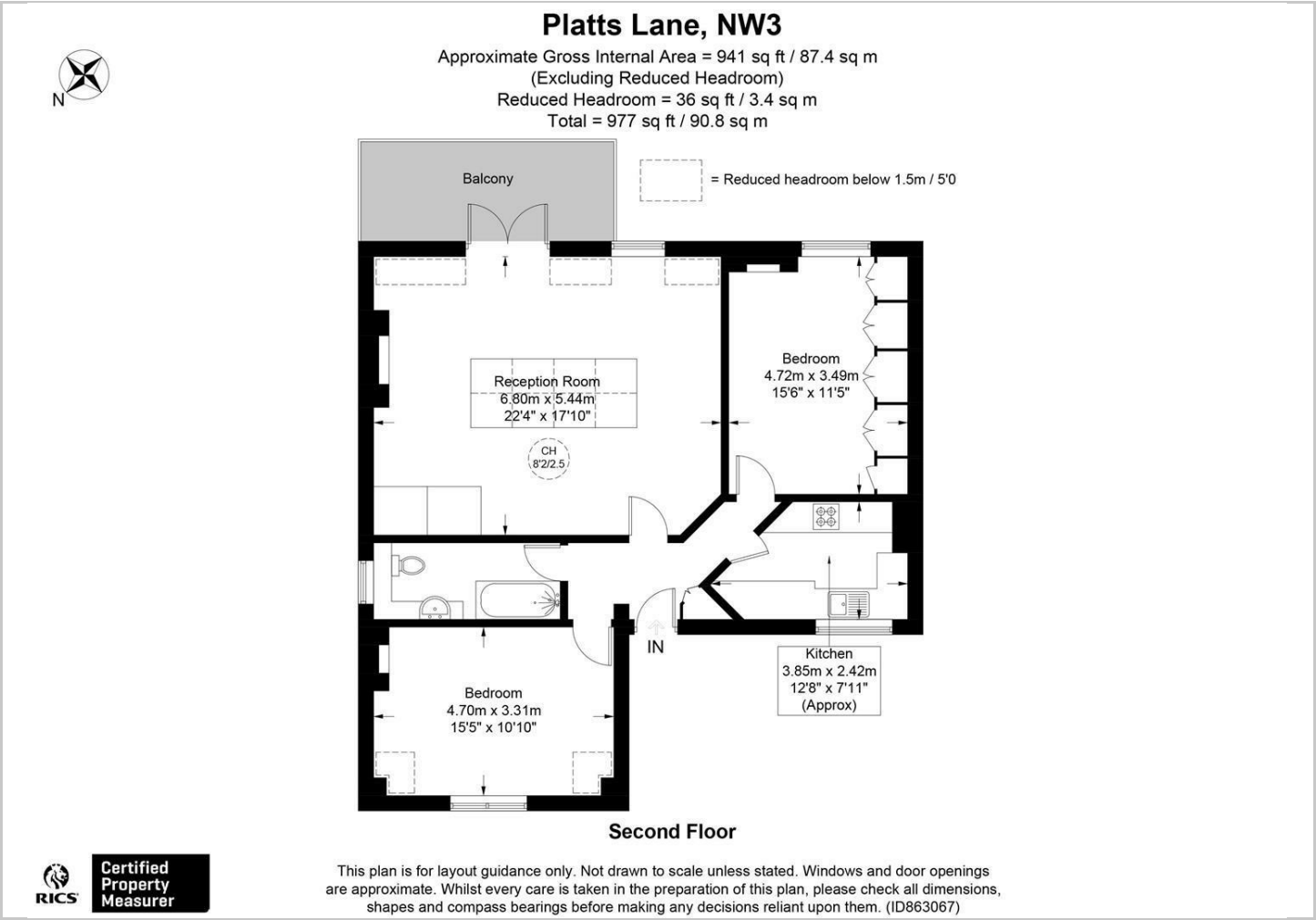

Energy Performance Graph

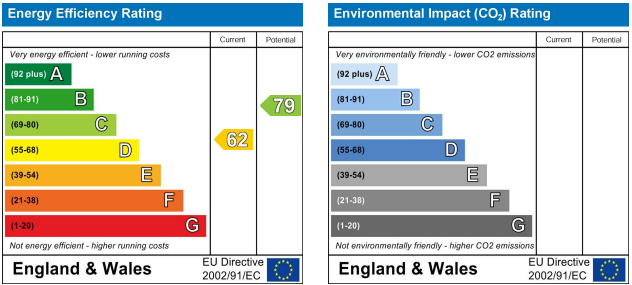

The particulars are set out as a general outline only for the guidance of intended purchasers or lessees, and do not constitute, any part of a contract. Nothing in these particulars shall be deemed to be a statement that the property is in good structural condition or otherwise nor that any of the services, appliances, equipment or facilities are in good working order. Purchasers should satisfy themselves of this prior to purchasing.